

**Notes:**

1. Horizontal alignment is based upon Ordnance Survey mapping with an approximate accuracy of +/- 1m.
2. Vertical alignment is based upon data supplied by EmapiSite.com. (5m elevation grid which has been contouroured - Digital Surface Model (DSM) with sub metre vertical accuracy (from +/- 1m))
3. All cycle and pedestrian accesses onto cycleway/footway are illustrative only, and subject to confirmation

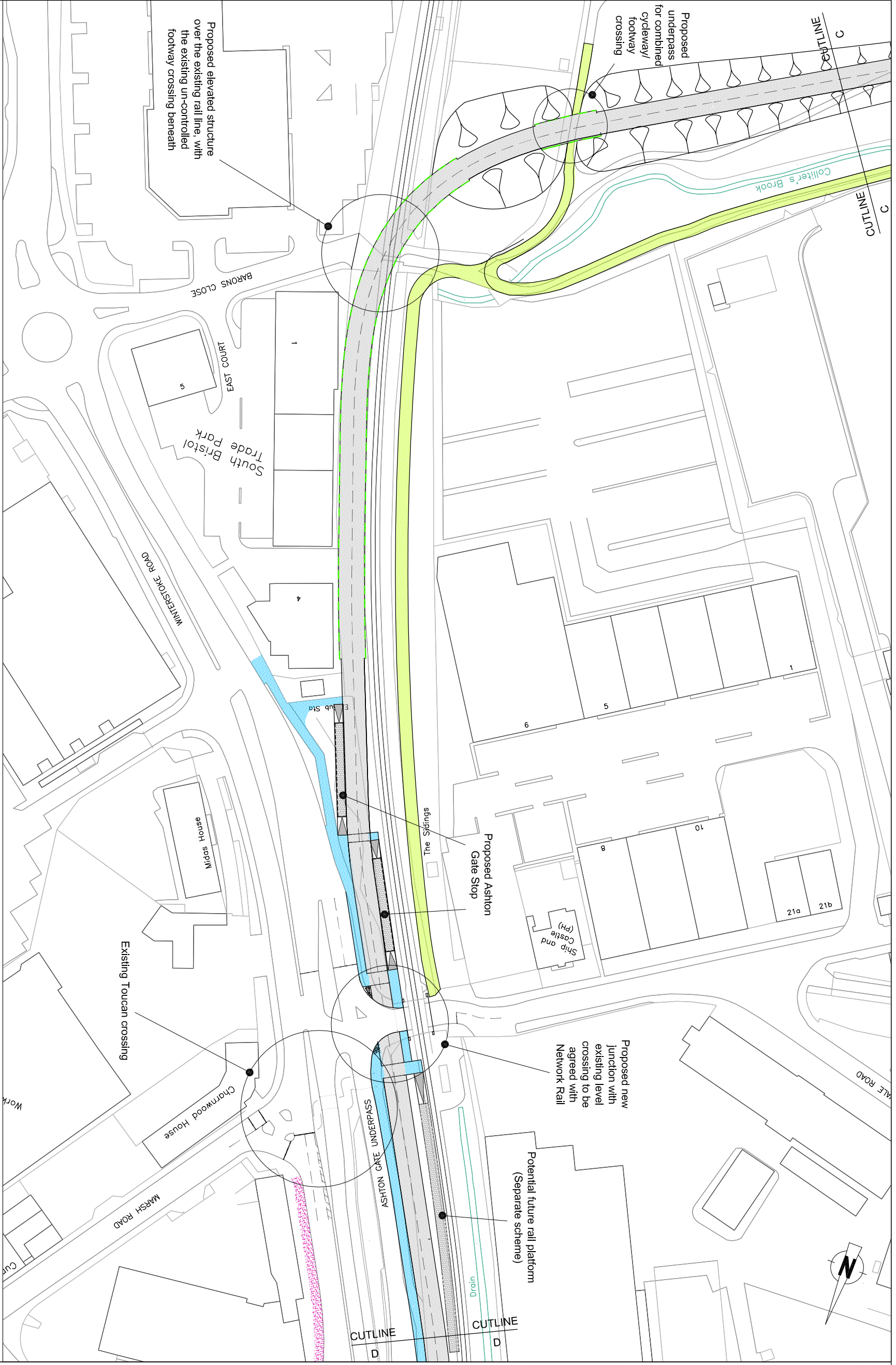

- LEGEND:**
- Proposed Un-Guided Rapid Transit
  - Proposed Train Slab Incorporating Bristol Harbour Railway
  - Proposed Combined 4m wide Cycleway/ Footway
  - Proposed Combined 3m wide Cycleway/ Footway

- Existing Combined Cycleway/ Footway
- Proposed Retaining Wall
- Potential Buildings to be Acquired
- Proposed Re-aligned Rail
- Existing Road
- Existing Footway

Rev	By	Chkd	Approved	Date	Description



**Halcrow**  
 WEST OF ENGLAND PARTNERSHIP  
 GREATER BRISTOL RAPID TRANSIT

**ASHTON VALE TO BRISTOL CITY CENTRE RAPID TRANSIT ROUTE LAYOUT PLAN SHEET 4 OF 10**

Drawn by: ADS  
 Checked by: ADS  
 Approved by: BS  
 Drawing No: CTRACF-0700-245  
 Date: 02/03/2019  
 Date: 02/03/2019  
 Date: 02/03/2019  
 Drawing Scale: 1:1250 @ A3