

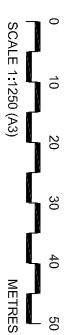

Floating Harbour

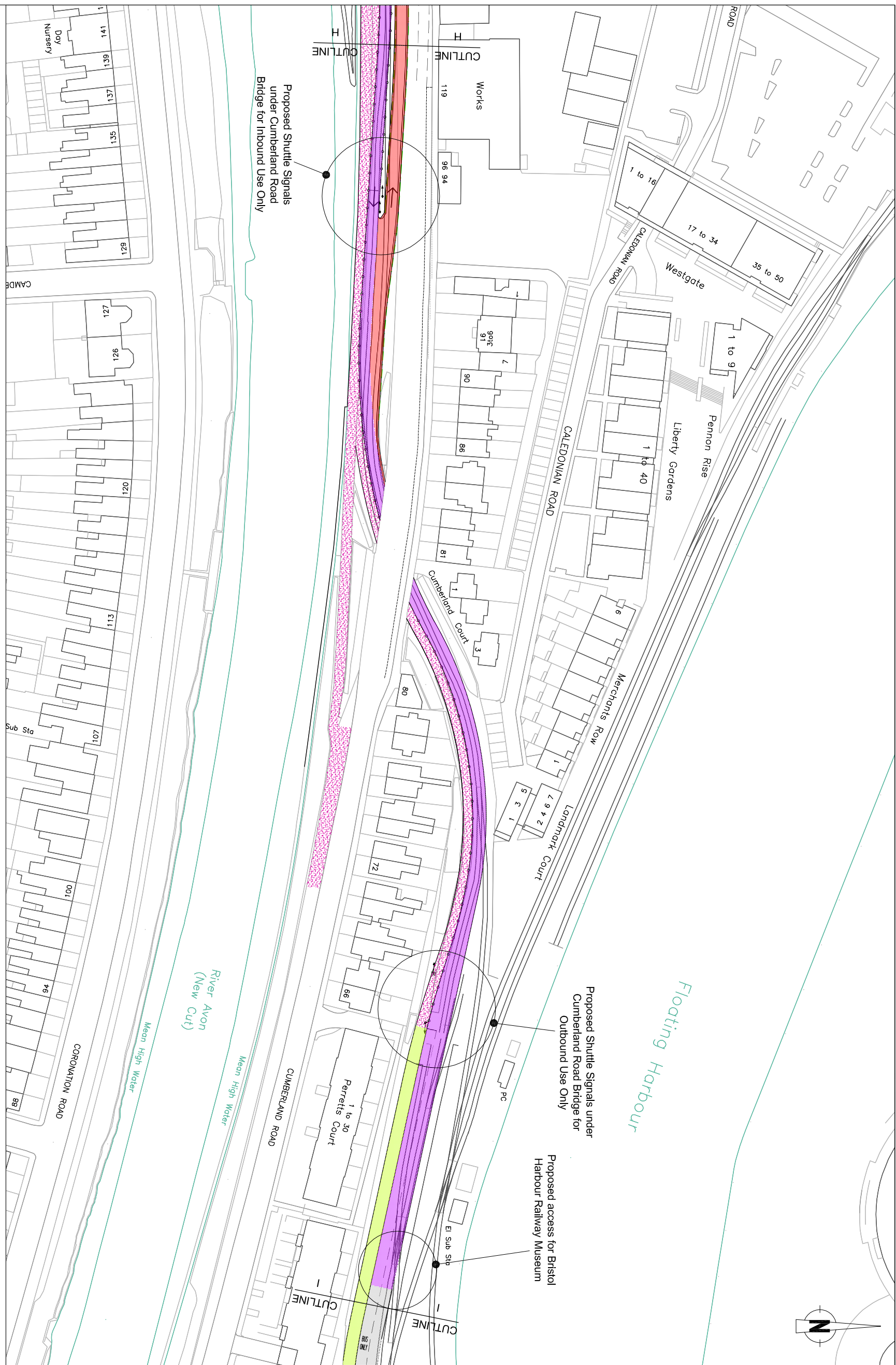

- LEGEND:**
- Proposed Un-Guided Rapid Transit
  - Proposed Train Slab Incorporating Bristol Harbour Railway
  - Proposed Combined 4m wide Cycleway/Footway
  - Proposed Combined 3m wide Cycleway/Footway
  - Existing Combined Cycleway/Footway
  - Proposed Retaining Wall
  - Potential Buildings to be Acquired
  - Proposed Re-aligned Rail
  - Existing Road
  - Existing Footway

**Notes:**

1. Horizontal alignment is based upon Ordnance Survey mapping with an approximate accuracy of +/- 1m.
2. Vertical alignment is based upon data supplied by EmapSite.com. (5m elevation grid which has been contoured - Digital Surface Model (DSM) with sub metre vertical accuracy (from +/- 1m))
3. All cycle and pedestrian accesses onto cycleway/footway are illustrative only, and subject to confirmation

Rev	By	Chkd	Appr'd	Date	Description

**Client**

**West of England Partnership**  
 Greater Bristol Rapid Transit

**Halcrow**

**Project:** WEST OF ENGLAND PARTNERSHIP GREATER BRISTOL RAPID TRANSIT

**Drawing:** ASHTON VALE TO BRISTOL CITY CENTRE RAPID TRANSIT ROUTE LAYOUT PLAN SHEET 9 OF 10

**Drawn by:** ADS      **Date:** 02/03/2019  
**Checked by:** ADS      **Date:** 02/03/2019  
**Approved by:** BS      **Date:** 16/03/2019

**Drawing No:** CTRACF-0700-250

**Drawing Scale:** 1:1250 @ A3

This map is reproduced from Ordnance Survey material with permission of Ordnance Survey on behalf of the Controller of Her Majesty's Stationery Office. © Crown copyright. Unauthorised reproduction infringes Crown copyright and may lead to prosecution or civil proceedings. Bristol City Council. Licence no. LA 09055L, 2002.