

PLAN OF EXISTING  
SCALE 1:250

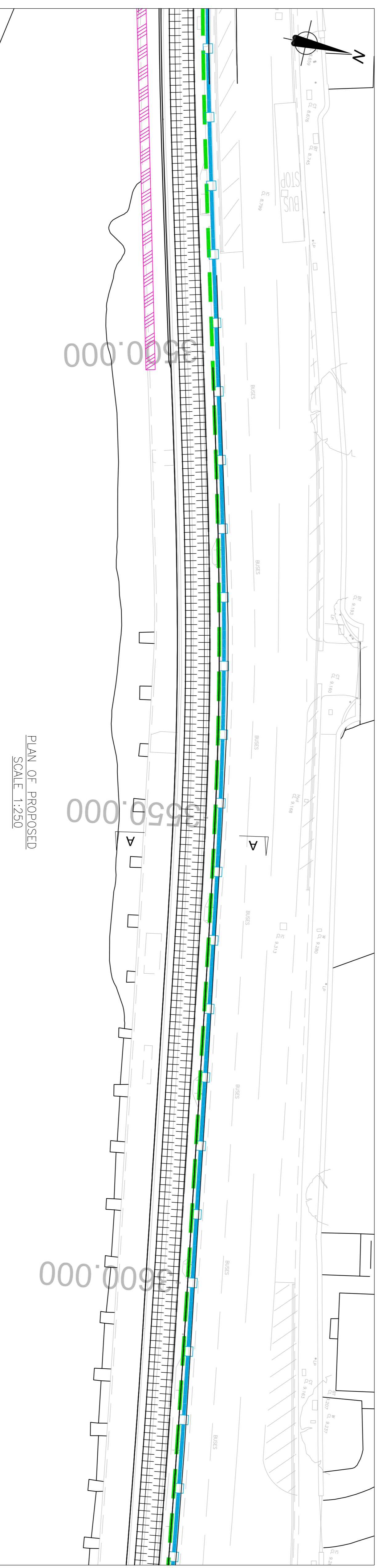

EXISTING SECTION A-A  
SCALE 1:50



PLAN OF PROPOSED  
SCALE 1:250

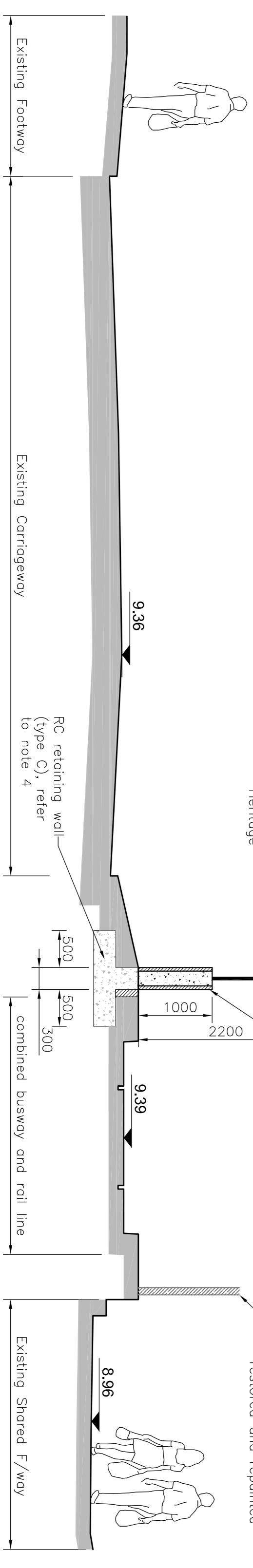

PROPOSED SECTION A-A  
SCALE 1:50

Replacement railings: Type and finish to be agreed with English Heritage

Vehicle restraint system: Pennant stone finish to match existing wall with the re-use of existing coping stones

Existing railings between the busway & rail line to be restored and repainted



Key Plan:

**Notes:**

- All dimensions are in millimetres unless shown otherwise.
- Levels are in metres A.O.D.
- This drawing to be read in conjunction with the Illustrative Corridor Section Design scheme
  - CTR ADU-0100-001 to 007;
  - CTR ADU-0110-001 to 007;
  - CTR ADU-0180-001 to 006;
  - CTR ADU-0200-008 to 017.
- Type of retaining wall provided depends on retained height; refer to plan for their locations and lengths.
- Flood trough to be integral with flood walls. Approximate area of flood trough slab = 600 m<sup>2</sup>. Flood walls to provide a flood protection height of 9.02m where gateway level is lowered to achieve the required headroom under Cumberland Bridge.
- Existing river footway where equal to the 9.05m flood wall level is to be locally adjusted to allow a 2.5m length of level footway passage over the flood wall. The footway then is to continue and slope down to the evacuation strip level with a 1:20 slope in the direction towards the bridge.

Rev	By	Chkd	Approved	Date	Description

Client

**West of England Partnership**

South West RDA

**Halcrow Group Limited**  
 Market House, 81 Jones Street, Chichester, West Sussex PO19 1UH  
 T: +44 (0)1243 849900 Fax: +44 (0)1243 538105  
 Email: [enquiries@halcrow.com](mailto:enquiries@halcrow.com)  
 www.halcrow.com

**Halcrow**

Project: **ASHTON VALE to TEMPLE MEADS and BRISTOL CITY CENTRE RAPID TRANSIT**

Drawing: **ILLUSTRATIVE CORRIDOR SECTION DESIGN CUMBERLAND ROAD RAMP EXISTING & PROPOSED CROSS SECTIONS @ CH.3550**

Drawn by: LW Date: 11/08/2010  
 Checked by: ADS Date: 12/08/2010  
 Approved by: DC Date: 12/08/2010

Drawing No. **CTR ADU-1700-4175-03**